

The monthly newsletter is a service to the community and our members. We welcome requests to research specific topics from the public and accept articles on local history. Please note that the Society reserves the right to accept or decline any article or material at its discretion. The Society is not responsible for the loss of or damage to any submitted material so please keep a copy for your records. Please include a note authorizing Anderson Historical Society to publish the material. We need two things from all members or those interested in local history: please be sure the Society has an updated email address and please spread the word to friends and neighbors about the Newsletter. Please contact us at: [www.andersonhistorical.com](http://www.andersonhistorical.com).

### Swasey Drive

Swasey Drive runs roughly north to south connecting Highway 299 just west of Lower Springs with Placer Road at the Centerville/Middletown Cemetery. The road was named for Benjamin Swasey who was born in Laconia, New Hampshire on 26 January 1822. He was the next to the last child of ten born to Benjamin Swasey (1784-1863) and Lydia Ladd (1784-1858). In 1845 he married Emily Marshall (1823-1868) in Massachusetts. By this marriage he had two children: Marshall B. Swasey (1846-1846) and Emily Augusta Swasey (1847-).

In October 1849, Benjamin joined a company of sixty-eight miners who sailed from New York City reaching San Francisco in February or March of 1850. After his arrival Benjamin went to Sacramento until October of 1850 when he moved to Shasta County and pre-empted land near Lower Springs. He returned east to bring his wife, Emily and child, Augusta to California by way of Panama. On returning to Lower Springs Benjamin mined, opened up a store, built a hotel, started a vegetable garden and fruit orchard as well as a nursery for trees and grape vines. From 1856 to 1860 he was elected to Public Administrator that required a lot of time away from home. In 1862 Benjamin sold his Lower Springs operation and moved the family to San Francisco. According to the 1867 Pacific Coast Directory Benjamin operated a photographic gallery on 3<sup>rd</sup> Street in San Francisco.

In 1868 his wife, Emily died. His daughter Augusta (Emily Augusta Swasey) had gained her majority and was living in Alameda County in 1870. She married Gilbert M. Daniels of San Francisco in 1876 and had four children. The family remained rooted in Alameda and San Francisco Counties.

In 1873 Benjamin married his second wife, Nellie Dalton (1847-). The couple returned to Shasta County in 1876 where Benjamin opened a photographic studio in Redding. The couple had at least three children: George H. Swasey born in 1875, Benjamin Swasey born about 1879, and Olive Swasey born about 1882. From 1881 to 1882 Benjamin served as Assistant Shasta County Assessor.

In 1900 the couple moved to Oakland, Alameda County. In the 1910 Census Benjamin was 88 years old living with his second son Benjamin and his wife Ruth (also their son Fred G. Swasey). Benjamin died in 1914 in Alameda County.

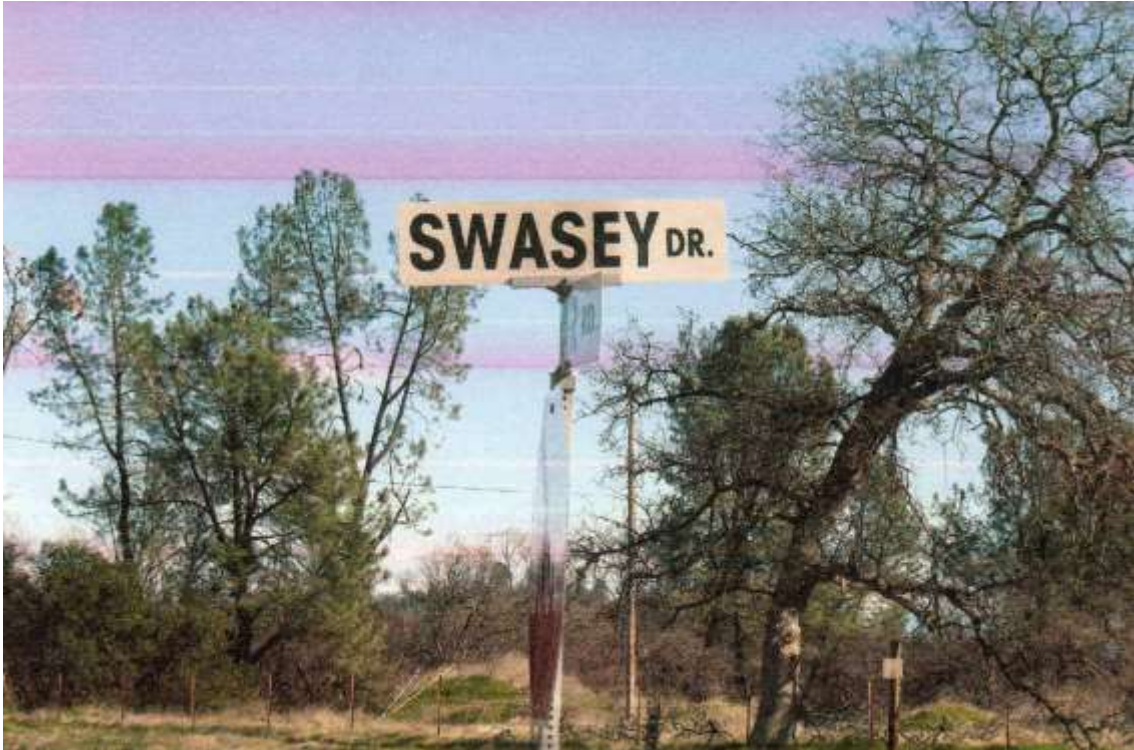

Junction of Swasey and Placer Road. Grant School is to the right and the Middletown/Centerville Cemetery is to the left behind the church.

## Sydney Jones House

What is commonly called the Sydney Jones House was initially the residence of Robert G. Harvey who was Superintendent of the Dry Creek Tunnel and Fluming Company. Prior to arriving in Igo he worked as a ditch agent at Blue Canyon in Placer County according to the 1870 census. He relocated to Igo sometime prior to 1880 because he is in the marriage records as marrying Jennie Terbush on June 24, 1880 (daughter of Kate Terbush, born in Saxony). In the 1880 census Robert is listed as 48 (born 1833 in Vermont as were his parents) and working as a miner. Jennie died in childbirth in 1882 but it appears the child Robbie G. Harvey survived as he is listed in the 1900 census. On January 19, 1900 Robert (age 67) married Carrie Boyce (age 33) who was born in California of Irish parents (the parents seem to be John Boyce a teamster and his wife Bridget).

Robert Harvey died in 1912 and is buried in the Igo Cemetery although the county index has him as Robert C. Harvey. The house passed to Thaddeus A. Jones who was the ditch tender for the Dry Creek Tunnel and Fluming Company. The home had burned in 1904 but was rebuilt. The transfer of the property had to have been prior to 1912 as Thaddeus (born December 8, 1832) died on January 21, 1912.

Sydie Stevens was born in Ono on August 7, 1885 (born in California while her father and mother were born in New York and California respectively) and sometime prior to 1910 married Stanley John Jones (born 8-27-1881 in California while his mother and father were born in Kentucky and New York respectively) a farmer who owned four land holding around Ono and Igo. Stanley may have been related to Thaddeus Jones as the house and surrounding land passed to Sydney. In the 1910 census Sydney was listed as a housewife but in the 1920 census she was listed as a teacher. This corresponds to the history that she had no formal education past the 9<sup>th</sup> grade but studied independently to pass the teacher's examination. She started her career in 1918 at Gas Point. Before settling down at the Igo School she taught in the Bald Hill School, Watson Gulch School and Centerville School. Sydney retired from teaching in 1944 but when the new school was to be built in Igo she donated the land. Stanley died on February 19, 1959 while Sydney survived until April 18, 1988.



The articles for May 2019 are: 1) Abstract of Title Heyler Ranch, 2) Zeis & Sons Ice Company, Redding, 3) The Afterthought Mine

#### Abstract of Title Heyler Ranch

An abstract of Title documents the history of a piece of property back to the original owner meaning the U.S. Government Land Office for Shasta County (excepting two Mexican era land grants). Abstracts are seldom seen any more as they are the topic of title insurance. When they are found they have a wealth of information about how business was conducted and influential members of the community. The article will be difficult to follow but it shows the complexity of land and water law in Shasta County. This title contains three parcels: 1) the south half of section 20, 2) the southeast quarter of the northeast quarter and the northeast quarter of the southeast quarter of Section 28, and 3) the north half of the northwest quarter of section 27, all in Township 31 North Range 1 West MDM. The title is also a 1/24 water right to the Sheridan Ditch and a 1/4 water right to the Nedrow Ditch.

The first document in the file is a note that no Government Land Office Patent was founded recorded for a homestead to William H. Ackerman for 160 acres described as the west half of the southwest quarter, the northeast quarter of the southwest quarter, the northwest quarter of the southeast quarter of Section 20 Township 31 North Range 1 West MDM. The transaction was noted in the Government Land Office records as a sale in May 1892 with a patent issued in

January 1899. In October 1898 Ackerman deeded the 160 acres to Elias Weigart in consideration of \$98.50. The deed was acknowledged by A. J. Dryman, County Clerk and A.F. Ross, Deputy Recorder. The deed included a two-thirds interest in water rights from the Sheridan Ditch.

1450  
1062

ABSTRACT

OF

TITLE

to all those certain lots, pieces or parcels of land situate, lying and being in the County of Shasta, State of California

and described as follows, to-wit:

S.  $\frac{1}{2}$  of Sec. 20, and S.E.  $\frac{1}{4}$  of N.E.  $\frac{1}{4}$  and N.E.  $\frac{1}{4}$  of S.E.  $\frac{1}{4}$  of Sec. 28, all in Tp. 31 N., R. 1 W., M.D.M.

---000---

TOWNSHIP 31 NORTH, RANGE 1 WEST

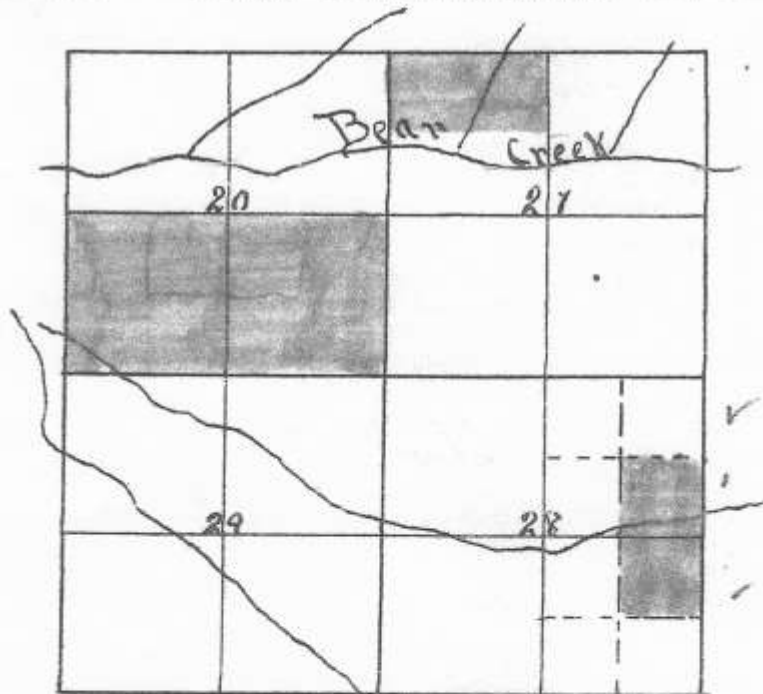

PLAT

of

Sections 20 and 28 of said Township, as per plat filed in the United States Land Office.

Elias G. Weigart received a Government Land Office patent dated June 1906 for the east half of the southeast quarter, the southwest quarter of the southeast quarter and the southeast quarter of the southwest quarter of section 20 Township 31 North Range 1 West MDM containing 160 acres. In August 1900 Elias deeded the west half of the southwest quarter to R. M. Weigart in consideration of \$75. The deed was acknowledged by James G. Estep, Notary Public. In August 1904 R. M. Weigart deeded back the eighty acres for \$75. The deed was acknowledged by Carl R. Briggs, Notary Public.

In May 1905 Elias Weigart and his wife Myrtle E. Weigart mortgaged the west half of the southwest quarter, the northeast quarter of the southwest quarter and the northwest quarter of the southeast quarter of section 20 (160 acres) for \$376 payable to Henry Butzback. The mortgage was acknowledged by W.D. Tillotson, Notary Public and A. L. Webb, County Recorder.

In February 1908 Elias and Myrtle Weigart deeded the south half of section 20 (320 acres) to Emanuel Yager in consideration of \$500. The deed was acknowledged by C. P. Dunham, Justice of the Peace for Millville Township.

The next document is a title search note that no Government Land Office patent was recorded but a note in the official record shows a patent was issued to Manson H. Wilson for eighty acres described as the southeast quarter of the northeast quarter and the northeast quarter of the southeast quarter of section 28 Township 31 North Range 1 West MDM. The sale was dated January 1882 and the patent was issued May 1884. Manson H. Wilson initiated a mortgage of the same property in June 1887 in consideration to George W. Sheridan. The mortgage was witnessed by E. F. Buss and Francis Carr, Notary Public.

Emanuel Yager deeded the southeast quarter of the northeast quarter and the northeast quarter of the southeast quarter of section 28 in Township 31 North Range 1 West MDM (80 acres) to Mrs. Barbara Yager in consideration of \$1,000. The deed was acknowledged by Walter S. Criss, Notary Public. In April 1904 Barbara Yager and her husband Emanuel deeded the eighty acres to Emanuel Yager, Junior. In May 1906 Emanuel Yager, Junior and his wife Amy O. Yager deeded fifty acres to Emanuel Yager, Senior for \$1.00 (described as the northeast quarter of the southeast quarter and the south ten acres of the southeast quarter of the northeast quarter of section 28 Township 31 North Range 1 West MDM).

In April 1912 Emanuel Yager, Junior and Amy O. Yager initiated a mortgage for \$850 payable to the Bank of Anderson. The property subject to the mortgage was 590 acres described as the north half of the north half of section 28, the north half of the northwest quarter of section 27, the south half of section 20 and thirty acres in the southeast quarter of the northeast quarter of section 28 all in Township 31 North Range 1 West MDM. The mortgage was acknowledged by C. D. Morton, Notary Public.

The next deed was from E.G. Weigart and his wife Martha E. (in the document it was signed Myrtle E.) to E. Yager, Junior. The deed dated October 1914 is for the south half of section 20 containing 320 acres for \$50.00. The deed was acknowledged by M. W. Woodard, Notary Public.

Emanuel Yager, Junior and Amy O. Yager initiated a Deed of Trust to the Bank of Anderson for \$2,500. The Trustees for the bank were W. C. Barklloo and H. E.

Black. The property in the deed was the south half of section 20, 30 acres in the southeast quarter and the northeast quarter of section 28 Township 31 North Range 1 West MDM. The deed was acknowledged by C. V. Davis, Notary Public and was satisfied in January 1915.

The next document was a Government Land Office patent dated January 1899 to William H. Ackerman for the west half of the southwest quarter, the northeast quarter of the southwest quarter and the northwest quarter of the southeast quarter of section 20 Township 31 North Range 1 West MDM containing 160 acres.

In Mar 1884 a Government Land Office patent was issued to Manson H. Wilson for the southeast quarter of the northeast quarter and the northeast quarter of the southeast quarter of section 28 Township 31 North Range 1 West MDM containing eighty acres.

Emanuel Yager deeded 320 acres to Emanuel Yager, Junior in January 1915. The property was the south half of section 20 Township 31 North Range 1 West MDM and the deed was notarized by Orr M. Chenoweth, Notary Public. In another deed dated the same day Emanuel Yager deeded to Emanuel Yager, Junior fifty acres described as the northeast quarter of the southeast quarter and ten acres of the southeast quarter of the northeast quarter of section 28 Township 31 North Range 1 West MDM. In January 1915 Emanuel Yager, Junior and his wife May O. Yager (previously given as Amy O. Yager) deeded the south half of section 20, the north half of the northwest quarter of section 27, and the north half of the northwest quarter of section 27, and the north half of the north half, southeast quarter of the northeast quarter and the northeast quarter of section 28 all in Township 31 North Range 1 West MDM to J. W. Heyler in consideration of \$10. The deed included a 1/12 interest in the George W. Sheridan Ditch. J. W. Heyler and his wife Annie C. Heyler initiated a mortgage on the property dated March 1915 for \$3,000 payable to Emanuel Yager, Junior.

In September 1879 the Government Land Office issued a patent to the Central Pacific Railroad as successors to the California & Oregon Railroad for the north half of the northwest quarter of section 27 Township 31 North Range 1 West MDM. The Central Pacific issued a deed to Henry Householder in consideration of \$120. Jas. O'B. Gunn and S. W. Sanderson were trustees. The next document is a Petition for Letters of Administration in the Matter of the Estate of Henry Householder. Henry died in September 1885 and his heirs were listed as Wilson Rupert age 41 from Shingletown, George Rupert age 40 of Cottonwood, Henry Rupert age 35 of Nevada City, and Susan Fry age 37 of Princeton, Colusa County. A. F. Ross provided an affidavit that notices were posted. At the hearing Adam Shuman was appointed Administrator under bond. M. H. Wilson, Jesse Boots and N.W. Ward were appointed appraisers and the real property was valued at \$200 and personal property was valued at \$470.55. Judge Aaron Bell approved the sale of the real property. The eighty acres was offered for sale and the highest bidder was M. Nedrow at \$1,200. The sale was confirmed by Judge Bell in January 1888 and a deed issued to M. Nedrow (acknowledged by Marrion Griffin, Notary Public).

The next document is a Water Right Notice for South Bear Creek dated November 1878. The notice was for 500 miner's inches of water taken from the



creek at a point where the east line of section 23 Township 31 North Range 1 West MDM crosses the creek. The notice was signed by M.H. Willson (previously Wilson), G. W. Sheridan and E. Smalley. In December 1887 George W. Sheridan deeded to Michael Nedrow (Nedrow) a 1/24 interest in the water ditch known as the Sheridan Ditch that rose from Bear Creek at Johnson's Island above the Bear Creek Falls and ran westerly. Another notice dated September 1887 by M. K. Wilson and M. Nedrow & Company claims a water right of 300 miner's inches from Bear Creek commencing at a point eighty feet above the bridge across Bear Creek on the S.J. Eldred Ranch and running west to the Nedrow and Wilson Ranches. Another notice of water appropriation followed for three hundred miner's inches of water from South bear Creek diverted on the west half of the northeast quarter of section 23 Township 31 North Range 1 West MDM and carried on the old Nedrow-Rupert Ditch and flume for irrigation of the southwest quarter of section 22, north half of the northwest quarter of section 27, north half of the northwest quarter and north half of the northeast quarter of section 28 Township 31 North Range 1 West MDM. M. Nedrow, N.D. Nedrow, A.L. Smith and R. M. Weigart each claimed a quarter interest.

The next document is from the Superior Court in the Matter of the Estate of Michael Nedrow, Deceased. Mary Nedrow petitioned for Letters of Administration stating that Michael died in April 1904. The property was listed as the north half of section 27 (80 acres) in Township 31 North Range 1 West MDM together with water rights. This was followed by an Order Setting Aside Whole Estate to Widow. Michael died intestate with the following family: Mary Nedrow, widow age 39, Mrs. Myrtle Weigart nee Nedrow age 17, Bertha E. Nedrow age 15, M. Ervin Nedrow age 13, Mable Nedrow age 11, Francis Nedrow age 8, and Teddy Nedrow age 3 (sons and daughters of deceased). The order was approved by Judge Charles M. Head and endorsed by W. O. Bloggett, County Clerk.

In December 1905 Mary Nedrow in consideration for \$600 deeded to Emanuel Yager, Junior the north half of the northwest quarter of section 27 Township 31 North Range 1 West MDM containing eighty acres and water rights. The deed was acknowledged by Carl R. Briggs, Notary Public. Emanuel Yager, Junior initiated a mortgage for \$600 payable to Emanuel Yager, Senior.

The next document is a note from the abstract company that there was no patent recorded but the Government Land Office had a note that George Rupert purchased the north half of the northwest quarter, north half of the northeast quarter of section 28 Township 31 North Range 1 West MDM containing 160 acres in April 1884. The patent was issued in April 1892 and was later recorded in the abstract.

In March 1866 a water claim was made by George W. Sheridan for water to be taken out of a dam to be built on Bear Creek on the land of J.A. Johnson at the lower end of Johnson Island and conveyed down the south side of Bear Creek by a ditch or canal surveyed by William Magee. The ditch was to be six feet wide at the top, three feet deep and four feet wide at the bottom and the water was to be used for irrigation purposes.

George Rupert initiated a mortgage for \$191 payable to A. F. Smith in February 1891 secured by the north half of the northwest quarter and the north half

of the northeast quarter of section 28 Township 31 North Range 1 West MDM. The mortgage was acknowledged by E. A. Martin, Notary Public.

In June 1888 M.H. Wilson deeded water rights to M. J. Rupert, wife of George Rupert. The deed was for one quarter interest in the Nedrow, Wilson & Wilkins Water Ditch taken out of South Bear Creek about one hundred yards above Bear Creek Falls and a quarter mile below S. L. Wilmer's Dam. The interest was for two hundred and fifty miner's inches of water for irrigation and other purposes. The deed was acknowledged by Florence Crowley, Justice of the Peace.

George Rupert initiated a mortgage for \$350.18 in March 1891 payable to A. F. Smith. The property used for the mortgage was the north half of the northwest quarter and north half of the northeast quarter of section 28 Township 31 North Range 1 West MDM (160 acres) and a quarter interest (50 miner's inches) in a ditch owned by the Nedrow Ditch Company (Michael Nedrow, Jesse D. Nedrow, George Rupert, and Mary Wilkins). The mortgage was acknowledged by E. A. Martin, Notary Republic and John R. Lowden, County Recorder. In December George Rupert initiated another mortgage on the property for \$709.21 payable to A. F. Smith.

In May 1895 George W. Sheridan deeded water rights to Albert F. Smith (a one half interest, 50 miner's inches, from a ditch constructed by G. W. Sheridan located at the lower end of Johnson Island on South Bear Creek). The irrigation ditch carried water to the farms of R. M. Weigot (Weigart), William Weigart, George Rupert and J. H. Adams. The deed was acknowledged by Walter S. Criss, Notary Public.

The next document is from the Superior Court: Petition for Letters of Administration in the Matter of the Estate of George Rupert who died in October 1895. The petitioner in 1896 was A. F. Smith, a creditor as the widow and children of George Rupert waived all claims to the Letters of Administration. The Court ordered the sale of the north half of the northwest quarter and the north half of the northeast quarter of section 28 Township 31 North Range 1 West MDM containing 160 acres and a quarter interest in the Nedrow Ditch to settle the estate. The highest bidder was Mrs. O. A. McCarley for \$1,000. The Administrator's Deed was issued in September 1903 and acknowledged by A. W. Smith, Notary Public.

Mrs. O. A. McCarley in November 1903 deeded the north half of the northwest quarter and the north half of the northeast quarter of section 28 Township 31 North Range 1 West MDM with the quarter water rights to the Nedrow Ditch to Emanuel Yager, Junior in consideration of \$10. Also in November 1903 a controller's Certificate was issued by the State of California to E. Yager, Junior showing redemption of state taxes for 1890-1894 and 1898-1903 (\$183.84). The redemption certificate included interest in the Sheridan Ditch and Nedrow & Rupert Irrigation Ditch.

Emanuel Yager, Junior initiated a mortgage in January 1906 for \$600 payable to Emanuel Yager, Senior. The property subject to the mortgage was the north half of the northwest quarter and the north half of the northeast quarter of section 28, and the north half of the northwest quarter of section 27 all in Township 31 North Range 1 West MDM containing 240 acres along with a quarter interest in the Nedrow Ditch and a 1/12 interest in the Sheridan Ditch. The mortgage was satisfied in May 1907 and acknowledged by A. L. Webb, County Recorder. The same property

was used by Emanuel Yager, Junior in April 1907 on a mortgage for \$650 payable to Mrs. Mary Owen O'Halloran. The 1907 mortgage was satisfied in August 1910. The same 240 acres were used by Emanuel Yager, Junior and his wife Amy O. Yager in March 1908 for a \$600 mortgage payable to C. G. Bechtle. The mortgage was satisfied in April 1912 and acknowledged by Louis L. Garrecht, Notary Public.

Emanuel Yager, Junior and his wife Amy O. Yager initiated another mortgage in April 1912 for \$850 payable to the Bank of Anderson. The mortgaged property used was 590 acres: the north half of the north half of section 28, the north half of the northwest quarter of section 27 and the south half of section 20 and thirty acres in the southeast quarter of the northeast quarter of section 28. The mortgage was acknowledged by C. D. Morton, Notary Public, and was satisfied in January 1915. Emanuel Yager, Junior and Amy Yager issued a Deed of Trust to the Bank of Anderson in July 1914 for \$2,500. The trustees for the bank were W. C. Barkuloo and H. E. Black and the deed was acknowledged by O. V. Davis, Notary Public. The property subject to the mortgage was only 240 acres rather than the 590 acres on the previous mortgage.

In January 1915 Emanuel and Amy Yager deeded to J. W. Heyler the south half of section 20, the north half of the northwest quarter of section 27 and the southeast quarter of the northeast quarter and the northeast quarter of the southeast quarter of section 28 all in Township 31 North Range 1 West MDM along with a 1/12 interest in the George W. Sheridan Ditch and a one quarter interest in the Nedrow, Wilson, Wilkins Ditch in consideration of \$10. The deed was acknowledged by Orr M. Chenoweth, Notary Public. The property was subject to a mortgage dated March 1915 for \$3,000 payable to Emanuel Yager, Junior. The mortgage was initiated by J. W. Heyler and his wife Annie C. Heyler. The mortgage was satisfied in June 1918 and acknowledged by H. C. Woodrum, County Recorder.

The last document in the abstract was a mortgage initiated by J. W. Heyler, a widower, for \$2,500 payable to the Federal Land Bank of Berkeley. There were some differences in the initial land description and the final mortgage. The mortgage is for 328 acres and does not include the south half of section 20 but includes both water rights. The initial document lists a 1/24 water right in the Sheridan Ditch while 1/12 seems to be correct. The final deed dated January 1915 is probably the correct description. The mortgage was acknowledged by Earl Lee Kelly, Notary Public.

#### Historical Notes:

MDM used in the text stands for Mount Diablo Meridian. The federal government survey selected base lines running north and south from a given point along which they could establish section and township corners. California has four such meridians: Gila-Salt River, Humboldt, Mount Diablo, and San Bernardino. All measurements in Shasta County use the Mount Diablo Meridian. The north-south lines are also called range lines and the description is in townships east or west of the base line i.e. 1 East, 3 West etc. A township is a rectangle measuring six miles on a side that is subdivided into thirty-six sections each one square mile or 640 acres. Townships are described as being north or south of the established base line i.e 3 North , 6

South. All of Shasta County is north of the Mount Diablo starting line. Sections are divided into a northeast quarter, northwest quarter, southeast quarter and southwest quarter each containing 160 acres. Quarters can be subdivided into quarters each containing 40 acres.

Ackerman, William H.: little data was found about William other than he received a homestead patent for 160 acres in 1899 for the west half of the southwest quarter, northeast quarter of the southwest quarter and northwest quarter of the southeast quarter of section 20 Township 31 North Range 1 West MDM.

Adams, J. H.: James Henry Adams was born in 1836 in Vermont. He was the son of John Adams 1788-1851 and Sally Jeffords 1792-1861. In 1865 James married Mary F. Boots born 1850 in Iowa while in Nevada. Mary was the daughter of Jesse Boots 1818-1888 and Eliza Ann Raney 1820-1910. In 1900 James was living in Shingletown and working as a farmer. In 1905 he received a homestead patent for forty acres (the northwest quarter of the northwest quarter of section 26 Township 31 North Range 1 West MDM). Mary died of complications of diabetes in 1904 and James died in 1905: both are buried in the Ogburn Inwood Cemetery. James and Mary had three children: Mabel 1875 California, Myrtle F. 1882 California-1929, and John Westley 1890-1967.



James Henry Adams, John Westley Adams and Mary F. Adams

Bank of Anderson: organized March 1905. Sold to First Savings Bank of Shasta County in February 1915 and they in turn opened a branch in Anderson.

Barkuloo, W. C.: president of the Bank of Anderson. William C. Barkuloo (Barkulow) was born about 1882 in Minnesota. He moved to Shasta County after 1900 and married Matie A. "Annie" McKinnon born 1882 in California. Annie was the daughter of William and Lola McKinnon of Anderson. After the bank sold the couple moved to Santa Clara County where in 1918 William was a bank auditor. William joined Surety Building and Loan Association and by 1927 was a secretary and by 1947 vice-president. William died in 1952 and Annie survived until 1970.

Bechtle, C. G.: Christian Gottfried Bechtle born about 1860 in Germany. Registered as a tinner in Shingletown in 1891. In 1910 he was listed as a contractor for cement work in Redding. In 1910 and 1930 he was a nightwatchman in a department store in Redding. Christian was married to Mamie Clark born about 1890 in California and the couple had two children: Christian Gottfried,

Junior 1909-1981 and Hilda Margaretta 1913-1984. Under the name Gottfried he had a homestead patent dated 1903 for 160 acres in section 14 Township 31 North Range 1 East MDM. He also had a cash sale under the name Christian G. for 158 ½ acres in section 6 Township 31 North Range 2 West. Christian died in 1944.

Bell, Aaron: was born in 1832 in Pennsylvania and came to California in 1852 where he mined on the Middle Fork of the American River. He remained in El Dorado County for sixteen years serving as Justice of the Peace, Deputy County Recorder, Deputy County Clerk and City Clerk of Placerville. He was an officer in the 2<sup>nd</sup> Battalion California Militia in 1863-1864 attaining the rank of Captain. He was admitted to the bar in 1864 and practiced land law in Sacramento for three years. The Government Land Office in Sacramento asked him to temporarily assist the Shasta Office and he liked the area. Later he accepted an appointment as Registrar of the Government Land Office in Shasta and served until he decided to run for the newly established Superior Court judgeship. Judge Bell was elected Shasta County's first Superior Court Judge in 1879. Judge Bell served in the Superior court until 1891 and supervised the transfer of the court system to the new county seat of Redding in 1888. Aaron also practiced private law and defended among others Sheet Iron Jack (AKA John Gundlack or John Allen) who went on to rob three stages in Shasta County. Judge Bell and his brother, a miner, invested in mines and timber land which included an interest in a box, shingle and lath factory. In 1874 Aaron married Julia Phipps (Fipps) born 1853 in Missouri who was a schoolteacher in Shasta. The couple had three children: Jessie born about 1875, George born about 1879 and Harvey born 1887. Judge Aaron Bell died in March 1903 and is buried in the Redding Memorial Cemetery.



Judge Aaron Bell

Black, H. E.: Harold Elmer Black born 1890 in California. He was the son of James Black a foreman at the brickyard in Anderson. Herald went to work for the

- Bank of Anderson becoming secretary. When the bank sold Harold went to work for the First Savings Bank of Shasta County and was assistant manager in 1918. Harold eventually transferred to the Bank of America and in 1940 was the manager of the Anderson branch. Harold married Beryl Audella Sisk born 1903 in California. Beryl was the stepdaughter of Karl Gustavis Moltzner of Anderson. Harold and Beryl had two children: Elizabeth M. born about 1924 and Richard E. born about 1906. Richard died in 1971 and Beryl survived until 1981.
- Blodgett, W. O.: William Ora Blodgett was born in 1863 in Missouri. Sometime between 1860 and 1870 William's parents Joseph Henry (1839-1905) and Eliza E. Blodgett (1830-1918) moved to California settling in Sonoma County. In 1895 William married Harriet J. McDuffie and by 1898 was teaching at Millville. In 1898 he was elected to his first term as Shasta County Clerk and was reelected in 1902. After 1906 he appears to have been Deputy County Clerk at least until 1920. William died in 1930 and Harriet survived until 1941.
- Boots, Jessie: was a farmer at Inwood when appointed an appraiser. He was born in 1818 in Virginia and married Eliza Ann Raney born about 1821 in Virginia. In the 1850 and 1860 U.S. Census the couple were farming in Iowa. By 1870 Jesse was listed as a miner in Nevada County. In 1871 Jesse registered to vote in Shingletown as a miner. In 1879 Jesse purchased 80 acres from the Government Land Office (the south half of the southeast quarter in section 22 Township 31 North Range 1 West MDM). Jesse died in 1888 and Eliza survived until 1910; both are buried in the Ogburn Inwood Cemetery. Jesse and Eliza had four children: Mary born 1850 in Iowa, died 1904 (married James Henry Adams), Sarah J. 1852-1857, John L. 1856-1857, and Martha E. born 1858 in Iowa, died 1904 (married Morgan Albery).
- Briggs, Carl R.: operated an abstract and title company in Redding known as C.R. Briggs & Company. The company produced the 1894 official map of Shasta County. Carl L. Briggs was born in 1852 in Ohio. In 1873 he married Agnes M. Williams in Illinois. In 1880 Carl was listed as a copyist with two children: Carl R. 1875 and Florence 1876. It appears that between 1880 and 1886 the couple divorced with the children remaining with their mother. In 1886 Carl registered to vote in Redding. In 1890 Carl married Anna V. Garrecht born in 1868 in California. The couple had three children: Nelda R. about 1895, Garrett H. about, 1902 and Elvene L. about 1908. Charles died in 1918 and Anna in 1924.
- Buss, E. F.: Elmer Frank Buss was born in 1856 in Sierra County. He was the son of Alfred Carter born about 1832 in New York and Martha Buss born about 1833 in Ohio. In 1860 his father was a hotel-keeper in Sierra County and by 1880 had moved to Fosters Bar, Yuba County. Alfred has at least three children: Solon C. about 1857, Elmer F. 1856, and Charles A. about 1861. In 1880 Elmer and Solon were in Butte County operating a bakery. In 1886 Elmer registered as a merchant in Anderson. By 1900 Elmer was a real estate dealer in Arizona and by 1920 he was living in San Diego County. Elmer was

known to have married Sarah Bell Harris. Elmer died in 1943 in San Diego County.

**Butzbach, Henry:** Henry Herman Butzbach was born in Michigan about 1856 and in 1910, was a blacksmith in Millville. Henry was the son of Philip and Amanda Butzbach who emigrated to the U.S. in 1848 settling in Michigan. Henry emigrated to Oregon but after six months moved to California where he tried work in San Jose, Pleasanton and San Francisco for a short while. Henry returned to Michigan where he married Amanda A. Arny (1865-1907) in 1888. In 1888 the new couple returned to California and settled in Shasta County at Millville. Henry established a blacksmith shop at Millville and quickly became a backbone of the community. Henry and Amanda had five children: Raymond H. about 1889, Edwin H. about 1890, Lester A. about 1895, Edith E. about 1897, and Clarence B. 1903-1959. Amanda died in 1907 and in 1909 Henry married Constance Choctaw Middleton (1876-1940). In 1920 and 1930 Henry was listed as a stock raiser in Millville. Henry died in 1939 and was buried in the Millville Masonic Cemetery.



Henry Herman Butzbach

**Carr, Francis:** was born in 1833 in County Donegal, Ireland. He was the son of James Carr 1777-1847 Ireland and Jane Dougherty 1800-1886 New York. James immigrated in 1852 and appears to have gone to Indiana where he filed an application for citizenship. By 1858 Francis was living in New York where he



married Cathern Cannon. The couple had one child Mary Jane (1859-1922). Cathern and her second child James both died in childbirth in 1861. In 1860 Francis was naturalized in New York. In 1863 Francis married Mary Ann McParland (1841 Ireland). In 1865 Francis was listed as a schoolteacher in New York with daughter Mary Ann and another daughter Margaret Ann born about 1864. In the 1870 U.S. Census Francis was still teaching in New York and the couple had three children: Mary Jane, Margaret Ann and Hannah born about 1868. In 1873 the couple gave birth to Theresa Ann (1873-1910; married Benjamin Macomber). In 1874 Francis was offered the position of principal of the Shasta Grammar School. Francis, Mary Ann and two children: Mary Jane and Theresa Ann sailed for Panama. Nothing was found about Margaret Ann or Hannah so there is a presumption they had died prior to 1874. The family settled into life in Shasta; Francis studied law and Mary Jane married in 1880 to William Henry Smith born 1852 in Illinois. In 1875 a son Francis Christopher was born (1875-1944; Shasta County Deputy District Attorney, Justice of the Peace and founder in the firm of Carr & Kennedy). In 1878 the couple's last child was born, William Peter (1878-1945). By the 1880 U. S. Census Francis was living in Millville and listed as an attorney. Francis died in 1896 and Mary Ann survived until 1920; both were buried in Old Saint Josephs Cemetery.



Francis Carr about 1874

Chenoweth, Orr M.: born in 1882 in Ohio. He was the son of Zenis and Mary Chenoweth who were in Shasta County by 1888 when Zenis registered as a clerk at Centerville. Zenis was later a dry goods merchant in Redding and a

partner in a candy and notions store. By 1910 Orr was practicing law in Redding. Sometime before 1912 Orr married Lotta E. McMurry born 1882 in California. Lotta was the daughter of Francis E. McMurry of Anderson. From 1910 to 1918 Orr was the Shasta County District Attorney. After returning to private practice Orr often represented Chris Kutras. Orr was a partner in Chenoweth & Leininger. Orr and Lotta had one child Lisbeth 1912-1994. Orr died in 1970 and Lotta survived until 1973.

Criss, Walter S.: Walter Scott Criss was born in 1863 in Carson City, Nevada. He was the son of Jacob H. Criss (1826-1908) and Martha P. Auld (1840-1908). By 1870 the family was living in Humboldt County and in 1886 in Placer County. In 1888 the family moved to Shasta County. In 1890 Walter registered to vote as a printer in Redding. He was believed to have worked for the Free Press and Democrat in Redding. In 1890 Walter married Harriet Ortense "Hattie" Comer (1872-1947) and about the same time moved to Millville and took over the Millville Tidings. Walter was editor of the Millville Tidings for fourteen years. In addition to being a Notary Public, Walter was elected Justice of the Peace for Millville in 1902. Walter died in 1904 and was buried in the Redding Memorial Cemetery. Walter and Hattie had two children: Martha Irene 1891-1969 and Gladys Aileen 1895-1991. Walter was the brother of Lincoln H. Criss of Shasta County.



Walter Scott Criss with Hattie O. Comer

Crowley, Florence: was born about 1833 in Ireland and had to have immigrated by 1850 as he was naturalized in Shasta County District Court in 1855. In 1866 he was listed as an expressman at Horsetown. By 1870 he was farming in Township 7 near Fannie Reading and W. Ludwig. In 1870 he was married to Cicilia born about 1857 in Ireland. In 1870 his older brother, Timothy was living with the couple and there were two entries on the agricultural census: Crowley & Brother with 100 acres tilled and 100 acres of other land and Florence with eighty acres tilled and one hundred and sixty acres of other land. Timothy appears to have died in 1876. In 1880 Florence was still in Township 7 with one hundred acres tilled, one hundred acres of woodland and forty acres of other land. Cicilia died in 1884 and is buried in Old Saint Joseph's Cemetery. In 1886 Florence last registered as a farmer in Cottonwood and no death date was found and there was no cemetery listing.

Davis, C. V.: nothing was found.

Davis, O. V.: nothing was found.

Dryman, A. J.: Angus James Drynan born 1852 in Canada. He was naturalized through his father who immigrated in 1858. In 1870 Angus was living with his mother Catherine (about 1840 Canada) in Nevada County where she operated a boarding house. In 1886 Angus registered in Igo as a saloon operator. From 1894 to 1898 Angus was the County Clerk. In 1900 Angus was a hotel manager in Keswick and from 1905-1910 he was Postmaster of Redding. About 1916 Angus moved to Sacramento where he died in 1932. Angus was married to Carrie Josephine Molter born 1859 in California (died 1946) and the couple were not known to have had children.

Dunham, C. P.: Charles Phineas Dunham was born in 1842 in Ohio. He was the son of Jonathan Dunham born 1813 Ohio (died 1894 in Shasta County) and Laura A. Dunham born 1817 Ohio (died 1900 in Shasta County). In 1850 the family was living in Illinois. Sometime prior to 1860 the family relocated to Millville. In 1869 Jonathan received a homestead patent in section 13 of Township 31 North Range 3 West MDM. In 1867 Charles registered to vote as a laborer in Millville. In 1870 Charles was listed as a farmer at American Ranch. In 1876 Charles purchased 160 acres in section 24 in the same township as his father. In 1883 Charles received a homestead patent for 160 acres in section 14 again in the same township as his fathers ranch. From 1886 to his death Charles was listed as a farmer in Millville. From 1902-1915 Charles was the Justice of the Peace for Millville. Charles was married to Cynthia Willard born 1852 and the couple had three children: Alice V. 1883-1930 married Willie Allen Aldridge, Charles M. 1884 -1947, and Jessie Leona 1886-1975 married Frank Darrah. Cynthia died in 1913 and Charles followed in 1918.

Eldred, S. J.: Stephen J. Eldred was born in 1831 in New York and was at Susanville by 1864. In 1870 he was listed as a stock raiser in Township 6 of Shasta County. In 1880 he was listed next to George Washington Sheridan on one hundred and sixty acres (30 tilled, 30 meadow and 100 other). In 1880 he was listed with what appears to be Marg Sunderland born about 1819 in Ohio as partner. By 1900 Stephen was listed in Anderson with wife Maria A.

born 1854 in Missouri. Stephen died in 1916 and is buried in the Anderson District Cemetery.

ESTEP, James G.: He was born in 1869 at Fall River Mills, California. He was the son of Alfred A. Estep and Rebecca McDowell. In 1890 he registered to vote as a farmer at Fort Crook. Shortly afterwards he attended law school at the University of Michigan and returned to Redding in 1894. In 1899 he was listed as a Notary Public and lawyer. In 1904 his offices were on Yuba Street. By family history he was the District Attorney but he was Deputy District Attorney under Thomas Dozier from 1898 to 1906. He was Judge of the Shasta County Superior Court in 1909 until he died of pneumonia or influenza in 1918. In 1896 he married Lillie Henderson (1875 Ohio) and the couple had four children: Romaine (Romaine) J. 1897 (died 1915), Catherine (Kathryne) 1900, Stanton H. 1904 and Horace W. 1909. James was a 1<sup>st</sup> Lieutenant in Company M 8<sup>th</sup> Regiment of California Infantry from July 1898 to February 1899. The unit was activated for the Spanish-American War but served in posts in California and Washington. James was a member of the Redding Fire Department in 1896.

Garrecht, Louis L.: Louis Lorenz Garrecht was County Assessor for three terms, 1922 to 1926, 1926 to 1930 and 1930 to 1934. He was the Son of Lorenz Garrecht and born in 1876 in California. In 1896 he was listed as a miner. In 1910 he was operating an abstract/title company in Redding. In 1899 he married Ruth Bell and the couple had two children: Ruth 1903 and Adair (Margaret Adair) 1907. Louis died in 1938.

Griffin, Marrison: the actual name was Marion Griffin. He was born in Indiana in 1858 and was the son of Charles Griffin 1808-1879 and Catherine Cain Sharp 1823-1868. Marion graduated from the Indiana State Normal School at Terre Haute and taught public school for two years. A number of close relatives developed consumption and Marion was advised to move to a better environment. In 1884 Marion moved to Napa County before moving to Cottonwood in 1885. Marion and his brother Scott Griffin went into the real estate business. The brothers produced advertising to induce settlers to the Cottonwood Valley. In 1887 the brothers purchased 400 acres in the Rogue River Valley in Oregon and laid out the town of Tolo of which Scott Griffin took charge. Marion married Martha Alice McCain (born 1865 in Oregon) in 1887. Alice as she was known had graduated from Anderson Normal School and taught in Shasta County prior to her marriage. In 1899 Marion relocated to San Francisco where he died in 1910. Alice survived until 1946 and both are buried in the Cottonwood Cemetery.

Gunn, Jas. O'B.: James O'Brien Gunn was born in 1844 in Canada. He was naturalized in San Francisco in 1879; he probably immigrated about 1854. In 1892 he was secretary of the Central Pacific Railroad. In 1900 he was listed as a capitalist in San Francisco. He died in 1912.

Head, Charles M.: Charles May Head was born in Arkansas in 1862. By 1866 his father Robertson Head 1827-1883 and mother Margaret Thompson 1838-1931 were settled in California. In 1886 Charles was listed as a clerk in San Joaquin County and by 1898 registered as a lawyer in Redding. Charles was

elected to two terms as Superior Court Judge beginning in 1903. Charles died in office in January 1914. Charles was married to Alpha E. last name unknown born in Montana in 1871 (died 1952) and the couple had one son: Gordon Garoutte 1899-1974.



Charles M. Head

Heyler, J.W.: Joseph W. Heyler was born in Pennsylvania about 1860. Joseph's father had emigrated from Luxembourg. In 1880 Joseph was a blacksmith in Pennsylvania. By 1900 he was still a blacksmith in Pennsylvania but married to Annie C. Smith born about 1856 in Pennsylvania. In 1900 the couple had two children Harris (Harry) Grover born 1886 in Pennsylvania and Daniel Talmage born about 1895 in Pennsylvania. In 1910 the family was in South Dakota where Joseph was farming. Sometime before 1915 the family came to Shasta County. Harry remained in South Dakota until the 1930s. The family purchased the property in Inwood in 1915. By 1920 Annie had died and Joseph was farming with his son Daniel. Joseph died in 1937. Daniel remained in Shasta County where he died in 1969.

Householder, Henry: appears to have been born about 1836 in Ohio and in 1867 was farming in Yolo County. In 1872 he registered to vote as a laborer in Shingletown. Henry is on the Probate Court record having died in September 1885 and was buried at the Ogburn Inwood Cemetery. He reportedly had eighty acres and left as heirs Wilson, George, Henry and Susan Rupert. All four are brothers and sisters and the children of Jacob Rupert born about 1815 in Pennsylvania and Mahala Rupert born about 1817 in Kentucky. Jacob and Mahala were living in Mendocino County with the four children in 1870.

In 1880 Jacob and Mahala were at Shingletown making shakes. Both Wilson and George are buried in the Ogburn Inwood Cemetery. No family connection was found between Henry and the four Rupert Children.

Johnson, J. A.: John A. Johnson was born in 1835 in Mississippi. In 1858 he was in Oregon and in 1860 was farming in Millville. He had 12 acres tilled and 148 acres of other land. In 1863 he registered for the draft at Millville and in 1865 had a cash sale for 160 acres from the Government Land Office (east half of the northeast quarter of section 22 and the west half of the northwest quarter of section 24 both in Township 31 North Range 1 West MDM). In 1860 he was married to Ruth Jane Johnson born in 1842 in Wisconsin and had two children Eugene born about 1858 in Oregon and Elizabeth C. born in 1859 in California. By 1870 the family moved on to Napa County where seven children were added: Catherine, William J., John Abner, Annie Laurie, Mary J., Charles E., and Robert E. John Abner died in 1897 in Yolo County and Ruth survived until 1928.

Kelly, Earl Lee: was born in 1892 in Oregon. He was the son of Fernando G. Kelly born 1856 in Illinois and Mary Kelly born 1869 in Iowa. During World War I Earl was assigned to Company M, 12<sup>th</sup> Infantry Regiment, 8<sup>th</sup> Division assigned to Camp Fremont in California but the unit was not assigned overseas. By 1920 Earl opened a title insurance business in Redding. By 1930 Earl was a successful realtor in Redding before being appointed California State Director of Public Works. In his capacity as Director he oversaw projects such as the Bay Bridge and the Tower Bridge in Sacramento. In 1939 L. M. Giannini appointed him vice-president of the Bank of America. Earl was a delegate to the Republican National Convention in Chicago in 1932 and later ran for Governor of California against Earl Warren in 1946 and against Goodwin Knight in 1950. Earl was married to Elsie Jessen born 1898 in California. Elsie was the daughter of Andrew and Frances Jessen of Anderson. The couple had three children: Earl Lee, Junior about 1923, Kathryn about 1926 and Loyd A. about 1929. Earl died in 1962.

Lowden, John R.: he was born about 1859 in Pennsylvania. He was the son of Thomas Lowden born about 1827 in England and naturalized in Shasta County in 1867. Thomas was a miner at French Gulch and in 1886 Justice of the Peace. In 1870 and 1875 John was listed as a butcher in French Gulch. He served two terms as County Recorder, 1894 to 1898 and 1898 to 1902. In 1885 he is listed as a salesman with McCormick, Saeltzer & Company in Redding. John was known to have managed the Golden Eagle Hotel in Redding. In 1910 John was a book keeper for a sawmill in Redding. In 1920 John was an accountant at French Gulch living with his sister Isabella and brother-in-law George R. Simmons. In 1883 John married Mattie L. Benton born about 1865 in California.

Magee, William: generally referred to as Colonel Magee. No military service was found but colonel is often a police title and William was the sheriff of Mobile, Alabama from 1836 to 1840. He was born in South Carolina in 1806. In his younger years he served as a deputy sheriff for seven years, a deputy U. S. Marshal for eight years and the Sheriff of Mobile for four years. In 1840

William moved to New Orleans and set up a mercantile business. With news of the Gold Rush he sold his business and arrived in San Francisco in 1849. Appointed Deputy U.S. Surveyor in 1854. County Surveyor from 1854 to 1856. Under Sheriff from 1856 to 1858. Purchased Four Mile House in Lower Springs in 1860. Contracted with the Latona Company to clear the Sacramento River channel in 1861 (and sell lots at Reading in 1863). Produced a map of Shasta County in 1862. Purchased 10 acres from Pierson B. Reading in 1865. Purchased rights to Iron Mountain in 1870 and when silver was discovered by James Salee in 1880 formed a company with himself, James Salee and Charles Camden (Lost California Mine). In 1885 listed his occupation as miner and by 1886 were operating a 20-stamp mill on the mine site. In 1878 he was appointed Deputy U.S. Mineral Surveyor. William was married three times: first to Margaret M. Bass with who he had one child, Caroline Virginia. His first wife died in 1869 and he married Mary Perry. Mary died in 1887 and in 1888 he married Ann L. Moon. William died in 1892. During his time in Shasta County he had 13 Government Land Office transactions. In 1860 he purchased 120 acres by cash sale and in 1862 purchased another 560 acres by cash sale. In 1862 he purchased 520 acres with Charles Camden. In 1862 he also had four script purchases: 161.45 acres with Charles Camden and Benjamin Carpenter, 160 acres with Charles Camden and Adam Coon, 160 acres with Charles Camden and Jacob Dunston, and 160 acres with Elizabeth Hunt, Charles Camden and Simon Johnson. In 1876 he received a mineral patent for 151 acres known as "gold hill."

Martin, E. A.: is probably Edward Amistad Martin who was postmaster at Inwood between 1905 and 1910. Edward was born in 1858 in California. His parents were Rufus F. 1826 North Carolina – 1893 and Martha J. Martin 1833 Tennessee -1908 who were settled as farmers at Millville by 1860. The family was in North Carolina in 1850 and came to California by 1858. From 1880 to 1910 Edward was listed as a farmer at Shingletown. Between 1910 and 1916 the family moved south and in 1920 Edward was a proprietor of a bakery in Stockton. In 1890 Edward married Sarah Adams born in 1870 in California and the couple had six children: Clifford 1891-1974, Gladys Aldine 1893-1969, Donald 1895-1962, Helen I. 1897-1972, Howard E. 1904-1982, and Gerald A. 1910-1968. Sarah died in 1916 and Edward survived until 1934.

McCarley, John W.: merchant at Texas Springs in 1866. He was born in 1829 in South Carolina. In 1850 John was listed as an overseer in South Carolina. In 1860 John was listed as a miner with Elizabeth age 19 and James Bedford. In 1870 John was listed as a farmer in Township 7. He purchased a Shingletown store in 1871 and with partner Albert F. Smith opened the McCarley & Smith General Store, Trading Post & Hotel. In 1880 John was listed as a merchant at Shingletown and owned 160 acres (5 tilled, 20 meadow and 140 woodland). In 1859 he married Olive Ann Bedford. From 1874 to 1884 he was Postmaster at Shingletown. John died in 1884 and was buried in the Ogburn Inwood Cemetery. In 1892 Olive purchased 160 acres in section 28 Township 31 North Range 3 East MDM. In 1900 Olive was listed as a

- merchant at Shingletown living with the Alfred H. Smith family. Olive died in 1919 and is buried in the Ogburn Inwood Cemetery.
- Morton, C. D.: possibly Claude Dillis Morton born 1873 in Michigan. He was a store-keeper in Keswick and Coram between 1900 and 1910. He was a County Commissioner for the Panama-Pacific Exposition of 1915. He was a trustee of Coram when it was incorporated in 1910. He was married to Iris Vanderhoff born about 1887 in California. The couple had a son William born about 1908. It is believe the family relocated to Sacramento after most of the copper mining operations were closed.
- Nedrow Ditch: most likely named for Michael M. Nedrow born 1832 in Ohio. In 1870 Michael and his wife Hannah Martha Raney born 1843 in Ohio were living in Iowa. By 1880 Michael was a farmer at Inwood listed with six children. In 1884 Hannah died. Michael remarried in 1887 to Mary last name unknown born 1866 in Iowa. The data suggests that Hannah had fourteen children: Louis 1860, Steven 1861, Mark Cummings 1863 Iowa-1921, Jesse 1866, Mary Frances 1867-1869, David Edward 1870-1871, Ellen P. 1871-1885, Nettie 1872, Emma 1875, John Henry 1879-1880, Sarah C. 1883-1885, Kittie 1883-1884, and Myrtle 1883. Mary also had four children: Bertha 1889, Iremy (possibly Jeremy) 1891, Mabel 1893, and Frances 1895. Michael died in 1904 and was buried in the Ogburn Inwood Cemetery. Two of Hannah's children married into the Weigart family: Myrtle married Elias G. Weigart in 1900 and Mark Cummings married Mary C. Weigart in 1892. In 1891 the owners of the Nedrow Ditch Company were Michael Nedrow, Jesse D. Nedrow, George Rupert, and Mary Wilkins.
- O'Halloran, Mrs. Mary Owen: nothing was found except that she registered to vote at Balls Ferry between 1900-1926. She may have been the wife of Dennis W. O'Halloran who had a cash sale in 1900 for forty acres (the southwest quarter of the northwest quarter of section 28 Township 31 North Range 1 West MDM).
- Ross, A. F.: Albert F. Ross, Senior (about 1861-1919) was the son of Herman Ross (1823-1901) who purchased the Bancombe Mill in Millville along with H. N. Wilkinson. Albert was Sheriff of Shasta County from 1892 to 1894 and again from 1914 to 1919 when he was killed in office. From 1896 to 1890 he was the combined Shasta county Recorder, Clerk and Auditor. Albert's son, Albert F. Ross, Junior was Shasta County Superior Court Judge from 1933-1962.
- Sanderson, S. W.: is probably Silas Woodruff Sanderson born in 1824 in Vermont. He served in the State Assembly for El Dorado and was a member of the California State Supreme Court before settling in San Francisco around 1880. He died in San Francisco in 1886.
- Schuman, Adam: was born in 1832 in Baden where he learned the trade of butcher. Adam's two uncles had settled in the United States and urged his father to sell and make the move. In 1851 Adam accompanied his father and settled on a farm in Illinois. After a few years Adam opened a meat market. In 1858 Adam moved to Red Bluff in Tehama County. In the draft registration of 1863 Adam was a teamster in Red Bluff. In 1874 the firm of Schuman and Price (W. F. Price & Company) was formed at Cottonwood. Price was William Franklin



Price born 1821 in Missouri, died 1901 in Cottonwood. The firm was a general merchandise store but also purchased and shipped wool and hogs. In 1875 Adam was an initial trustee of the Oak Knoll School District. In 1854 Adam married Elizabeth Slater born 1829 in Baden and the couple had four sons all of whom died early. The couple had one daughter, Lucinda born in 1862 who married J. H. Campbell. Elizabeth died in 1907 and Adam in 1909; both are buried in the Cottonwood Cemetery.

Sheridan Ditch: probably named for George Washington Sheridan 1830-1900 who purchased a 160-acre parcel from P. B. Reading in 1855 with his partner John Wilson. In May 1859 he purchased the Sylvester Langdon Ranch that was settled in 1853. The ranch became part of Inwood and remained in the Sheridan family until 1896. George helped build the first Bear Creek School on the South Fork of Bear Creek. Martha Sheridan, George's wife was a sole trader in 1861. Sheridan Creek is named after George. George was born in 1830 in Kentucky. He was married to Martha A. Sheridan born 1841 in Ohio. The couple had six children all born in California: Louis Oliver 1859, Adelbert O. about 1861, Ackie born about 1863 (married J. E. Crews), Artie C. born about 1864 (married Aaron Milton Heryford), John S. born about 1866, and Edward A. 1870. George died in 1900 and was buried at the Millville Masonic Cemetery. Martha received a homestead patent for 120 acres in sections 5 and 6 of Township 32 North Range 1 West MDM. George had three transaction with the Government land office: a script sale in 1863 for 160 acres in section 28 of Township 31 North Range 1 West MDM, a cash sale for forty acres in 1865 in section 28 Township 31 North Range 1 West MDM, and a homestead in 1894 for 160 acres in sections 22, 23, and 27 Township 33 North Range 2 East MDM.

Smalley, E.: Elijah Smalley was born in 1840 in Ohio who registered for the Civil War draft at Cloverdale in California. In 1870 he was listed as a log chopper in Township 6 of Shasta County. In the 1880 U.S. Census he was living near Michael Nedrow and listed as a woodsman. With Elijah was Parlee Caladonia Elzey born about 1835 who was listed as a glove maker and their daughter Mary Edna born in 1877 (Parlee had been previously married but the children of that marriage were not with the couple in 1880.) In 1900 Elijah was listed as a board-maker and in 1910 a farmer in Shingletown. Parlee died in 1916 and Elijah in 1919; both are buried in the Ogburn Inwood Cemetery.

Smith, A. F.: Albert F. Smith was born in 1859 in South Carolina. In 1870 re was listed as a sawyer in Township 6. In 1871 he joined John McCarley in establishing the McCarley & Smith General Merchandise, Trading Post and Hotel in Shingletown. The Company eventually expanded to a store in Cottonwood. Albert also purchased timberland and operated the Al Smith Sawmill. Albert married Virginia Olive last name unknown born in 1859 in Mariposa County and the couple had four children: James E. about 1870, Albert W. about 1875, Olive 1882 and Sarah 1889.

Smith, A. L.: nothing found.

Smith, A. W.: Albert W. Smith was the son of Albert F. Smith born in 1875 in California. In 1899 he was listed as a Notary Public in Shingletown and in

1900 was a clerk at the McCarley & Smith store in Shingletown. In 1910 Albert was the secretary of a power company in Redding. By 1920 Albert had moved to Sacramento where he operated a wholesale grocery. Albert was married to Daisy Irene Lennon born 1883 in California. Daisy was the daughter of Edward and Elizabeth Lennon of Tehama County. Daisy and Albert had one son Albert Edward 1903-1950.

Tillotson, W. D.: Willard D. Tillotson born in 1861 in Ohio. Willard was the son of James Hooker Tillotson and Angelina Denton. He began the practice of law in Tacoma, Washington where he was also a member of the State legislature. From 1891 to 1893 he was U.S. Consul to Japan and Judge of the Consular Court. Willard moved to Redding in 1896 and set up a law practice that represented many of the large mining companies. In 1905 he was part of Sweeny & Tillotson in the Golden Eagle Block in Redding. From 1906-1910 he served as District Attorney and from 1914 to 1916 Superior Court Judge. In 1912 he was a delegate to the Republican National Convention in Chicago. From 1916 to 1937 Willard was the Redding City Attorney. Willard was married to Etta K. Tillotson born about 1865 and the couple had one daughter named Alice born about 1890 in Washington. Etta died in 1941 and Willard died in 1952.

Ward, N. W.: is Nathan W. Ward born in 1854 in Illinois. He was the son of Levi Ward and Frances Robinson. In 1880 he was living with his mother Frances born about 1822 in Tennessee and his three brothers: Jonathan 21, Marion 17 and Levi 15 all born in Kansas. All four brothers were listed as clearing a farm. Nathan married America Eveline Yokum the former wife of Richard William Morgan in 1887 in Shasta County. By the 1900 U.S. Census Nathan was living in Oregon presumably divorced from America as Nathan married Mary Angeline May the widow of Nathaniel Hamlin in 1907. Nathan died in Oregon in 1935.

Webb, A. L.: WEBB, Abraham Lincoln: farmer in Redding in 1898. He was born in 1865 in Shasta County. He was the son of John Paxson Webb and Rebecca M. Boyes who settled in Millville in 1858. He served three terms as County Recorder, 1902 to 1906, 1906 to 1910, and 1910 to 1914. In 1887 he married Katie F. Jenkins (1871 California) and the couple had a son Myron Clay 1889.

Weigart, Elias G.: born about 1804 in Kentucky. Married to Mary P. Weigart born about 1810 in Kentucky. In 1880 Elias and Mary were in Fletchall County, Missouri. Elias two sons and their family came to Inwood, Shasta County about 1892: Robert M. born 1848 in Iowa and William born about 1840 in Iowa. Elias had two other sons Joel born about 1854 in Iowa and Leslie born about 1850 in Iowa. Note: the Elias G. Weigart in the deed is the son of Robert M. born about 1876 in Missouri. Elias first married Myrtle E. Weigart then Martha Weigart. Elias died in 1969 and is buried in the Millville Masonic Cemetery.

Weigart, Robert M.: born 1848 in Iowa; married to Virginia Weigart born about 1865 in Iowa. In 1880 the family was in Missouri and moved to Inwood about 1892. Robert and Virginia had at least six children: Mary Catherine 1874 Missouri, Elias G. about 1877 Missouri, Erilla about 1879 Missouri, Ida O.

- about 1889, Rose M. about 1893, and Philip W. about 1894. Robert's daughter Mary Catherine married Mark Cummings Nedrow born about 1863. Robert died in 1905 and is buried in the Millville Masonic Cemetery.
- Wilkins, Mary: nothing was found other than Mary Wilkins and William T. Wilkins received a homestead patent in 1889 for 160 acres (the southwest quarter of section 22 Township 31 North Range 1 West MDM).
- Wilmer, S. L.: probably Samuel L. Wilmer born in 1818 in New York. In 1870 Samuel and his wife Mary born in 1826 in New York were farming in Iowa. In 1880 Samuel was listed in the Reading Precinct near George Dersch. In 1886 he registered as a farmer at Shingletown and in 1889 purchased eighty acres from the Government Land Office under the name Willmer. The eighty acres was the south half of the northeast quarter of section 22 in Township 31 North Range 1 West MDM. In 1900 Mary died and was buried in the Ogburn Inwood Cemetery. In 1900 Samuel was listed as a farmer and widower and no further entries were found.
- Wilson, Manson H.: Manson Hawthorne Wilson was born in 1824 in Kentucky. By 1840 he was living in Arkansas. In 1843 he married Nancy Lean Mock born about 1825. By 1871 Manson registered as a lumberman in Shingletown. In 1884 he received a patent for 80 acres. In 1887 he registered as a farmer in Shingletown but by 1892 was registered in Anderson. In the 1900 U.S. Census, Manson and Nancy were living in Anderson. Neither were found in the cemetery listing for Shasta County.
- Woodrum, H. C.: Henry "Harry" C. Woodrum served five terms as County Recorder, 1914 to 1918, 1918 to 1922, 1922 to 1926, 1926 to 1930 and 1930 to 1934. He was born in 1877 in California. He was the son of Henry Clay Woodrum and Anna Reid. In 1885 he was listed as a farmer in Redding. While working at the Terry Mill in 1895 he was severely injured and had to use crutches the rest of his life. He attended business school in San Francisco and studied telegraphy. He opened up the telegraph office at the St. Francis Hotel and in 1910 was listed as a telephone operator in Redding. In 1911 he became City Clerk of Redding until 1914 when he was elected County Recorder. In 1914 he was succeeded as City Clerk by Edith E. Hemsted who held the job until 1916 when she married Henry. Edith was born in 1888 in Shasta County and was the daughter of Dexter T. and Sarah Alice Hemsted. Edith was the first woman elected to public office in the county. Henry died in 1937.
- Woodward, M.W.: Marvin William Woodard was born in 1845 in Wisconsin. In 1867 he was listed as a student at Santa Clara. In 1896 he registered as a nurseryman at Manton. Between 1904 and 1911 he was the first and last Postmaster at Wanamine (Winamina)(operations moved to Manton in 1911). From 1910-1920 Marvin was listed as a farmer in Shingletown. Marvin married Emily A Valentine in Alameda County in 1885 and the couple had three children: Arthur V. 1886-1909, Ralph born about 1891 and Frederick Roy 1893-1981. Marvin died in Contra Costa County in 1927 and Emily survived until 1938.
- Yager, Emanuel: born Emanuel Joseph Yager in 1847 in Austria. He came to the United States with his father and was naturalized through his father. In 1870

he married Barbara Yager born about 1853 in Austria. In 1873 the couple were in New York but by 1878 they were listed in San Francisco where Emanuel was a tobacconist and Barbara as a cigar maker. Emanuel was a linen miller by trade but became a cigar maker. In 1892 the family moved to Inwood where Emanuel purchased a portion of John Rupert's Ranch and continued to make cigars. In 1903 Emanuel received a homestead patent for 160 acres described as the southwest quarter of section 26 Township 31 North Range 2 West MDM. In 1900 Emanuel was listed as a farmer in Shingletown and Barbara a cigar maker. In 1910 both were listed in Shingletown as owners of a cigar factory. In 1909 Emanuel established a cigar store and factory in Redding that would evolve into the Grindstone Club. Emanuel and Barbara were known to have three children: Josie born about 1873 in New York, Caroline born about 1875 in California, and Emanuel, Junior 1881. Emanuel Joseph Yager, Senior died in 1923.

Yager, Emanuel, Junior: born 1881 in California. He was the son of Emanuel Joseph and Barbara Yager. Emanuel married Amy Olive Thatcher born 1885 in Millville and the couple had three children: Olive about 1907, Retta about 1905 and Lester Emanuel 1907-1976. In 1910 Emanuel was listed as a farmer in Shingletown. In the 1920 U.S. Census he was listed as a grocery clerk in Redding and in 1930 as a life insurance agent. Emanuel Joseph Yager, Junior died in 1931 and Amy survived him until 1961.

### Zeis & Sons Ice Company

The story of the Zeis Ice Company also called Redding Ice Bottling Works begins with John Zeis who in the 1880 U. S. Census was listed as being born in Byron (which seems to be a corruption of the German word for the Kingdom of Bavaria) in 1846. By family history John settled in Chicago in 1867 after immigrating in 1865. In Chicago John married Louisa Schink or Schenek who was born in the Kingdom of Wurttemberg about 1845 and immigrated to Chicago in 1866. By 1880 John was a farmer with five children living in Washington, Washington County, Oregon (about twenty miles west of Portland in the northwest corner of Oregon). The couple had resided in Oregon at least since 1871 as all five of the children were born in Oregon. The five children in 1880 were: Theodore 9, A. Edward 7, Amiel 5, F. John 3 and Louis 1. There was a sixth son born in 1881 in Oregon named Fred (Fritz). Most of the children's names underwent changes from the German form to the American form. By 1900 the children were listed as Theodore, Edward August, Emil Robert, John F., Lewis Herman (Louie), and Fred Will.

The period around 1900 was one of change for the Zeis family. John was living in Benton, Corvallis County, Oregon and listed as an ice manufacturer. In addition to Louisa three children were listed: Fred working as a day laborer, Louis working as a day laborer, and John working as a laborer in an ice works. Edward was listed in Redding as an ice and soda manufacturer. Also living with Edward was Frederick Zeis age 18 (also listed in Oregon). Theodore was also listed as living in Redding and working as a clerk in an ice and soda works. Emil Robert was not found

on the 1900 U. S. Census but by 1910 he was listed as a saloon owner in Redding. John F. seems to be the only family member who did not make the move to Shasta County (he was in Corvallis County in 1900 and a partner in a hotel in Portland, Oregon in 1910).

By family history John was looking for a more thriving community so in 1892 took the train to Redding. As he got off at the depot he saw the Ruggles Brothers just after they were lynched for killing a popular stage driver. John took the next train back to Oregon and by family history stayed there until September 1898. By family tradition the family moved to Redding in 1898 where John and the two oldest boys Theodore and Edward purchased a soda plant on the corner of South and Oregon Streets from the Delinger estate. At the time ice was shipped to Redding by railroad car from San Francisco. In 1901 Zeis and Sons hired Julian Martin Rasmusson to supervise the building of an ice plant in Redding. The ice was cut into blocks and delivered to homes and businesses and the delivery wagons became a fixture of early Redding. Zeis and Sons also operated a bottling plant that produced seltzer and different flavored drinks.

After a number of years the ice business was sold to the Union Ice Company that established a branch in Redding in 1913 and the soda operation moved to a building Zeis & Sons built on the corner of Oregon and Sacramento Streets. In 1934 the bottling operation was sold to George Frickinger and Dave Jackson, and during the late years Zeis & Sons was just bottling Coca-Cola, 7-up, and Acme Beer (the Acme Company was founded in San Francisco in 1907 and produced Acme Brew, a near-beer, during probation). One block in Redding was known as the Zeis Block for the Zeis Building on Market and Butte Streets build by John, Senior in 1906. The building was eventually purchased by Theodore (Teed) and housed a bar on the corner, businesses downstairs and a rooming house upstairs. In 1902 when the Redding ice plant was being updated with a twenty-five ton refrigeration unit the small refrigeration unit was moved to Delamar where Zeis & Sons were going to build a branch ice factory. Fred Will may have operated the branch plant as in 1910 he was listed as proprietor of an ice and soda factory and living in the Sacramento River Precinct (although family history cites Emil as operating the plant). The plant may have closed after the copper boom ended as by 1918 Fred Will was listed as an employee of Zeis & Sons in Redding.

John, Senior died in Redding in 1921 and Louisa survived to 1933. Both are buried in the Redding Memorial Cemetery. Their oldest son Theodore Christian moved to Redding in 1898 where he registered as an engineer. In 1900 he was listed as clerk of an ice and soda works and in 1910 part owner of the ice works and in 1920 manager-owner of the ice works. After 1920 Theodore retired and purchased the Zeis Building from his father.

Theodore Christian was listed as marrying Edith May Walton (born in California in 1880 in Shasta County) in 1899. Edith and Theodore had one child Melvin born 1900 in California. In the 1910 U.S. Census Edith was not listed and no reason was found why. In the 1910 U.S. Census his parents John and Louisa were living with him. The cause of his parents moving in probably was the result of a fire in 1907 that started in John's wood shed and spread to the ice plant and nearby residents and two churches. The ice plant had \$25,000 in damage and \$10,000 in

insurance and John's home had \$6,000 in damages. Theodore's house sustained about \$300 in damage. By 1920 Theodore was married to Agnes Elizabeth Zeis born 1877 in Missouri and the couple was living with Agnes two daughters: Amy Ferrell born about 1901 in California and Artie born about 1904 in California. In the 1932 U. S. Census Theodore was retired and he and Agnes were listed with Melvin Zeis. Theodore died in 1932 and Agnes survived until 1961 (both are buried in the Redding Memorial Cemetery).

The second child of John and Louisa was Edward August born 1872 in Oregon. In 1895 at Benton, Oregon he married Ivy M. Ajar born 1877 in Oregon. Ivy's name is also given as Ivey and Iva, which is used on her headstone. Ivy's last name is also given as Apgar and Apjaes. The couple had no children. In 1900 Edward was living in Redding as an ice & soda manufacturer. Living with the couple was his brother Frederick (clerk in the ice company) and his father-in-law Fred Ajar born 1852 in Ohio who was working as a blacksmith in Redding. In 1910 Edward was listed as part owner of the ice works and 1920 manager of the ice works. In 1930 Edward was listed as a soda maker at a soda factory and in 1940 he was retired. Edward died in 1952 and Iva died in 1962; both are buried at the Redding Memorial Cemetery.

The third child of John and Louisa was Emil Robert born in 1875 in Oregon. By family history Emil married Amalie Gerhardine Klueman in 1900 but no census record was found. Amalie was born in Oldenburg, Germany in 1875. By family tradition the couple moved to Winthrop near Delamar where he operated the bottling plant in the early 1900s. Amalie or Amelia's parents were Gerhard George Klueman born 1844 and Johanna Wilks who were married in Germany in 1872. Gerhard reportedly moved to the Kingdom of Hawaii to build smoke stacks for sugar refineries. Gerhard moved to Happy Valley in 1893 when the area was strongly connected to sugar producers Alexander and Baldwin. Gerhard died in 1900 and Johanna died in 1932 (both are buried in the Happy Valley Cemetery).

By 1910 the couple had two children: John William "Bud" born in 1902 and Celena born 1904 and Emil was listed as a saloon owner in Redding. For the draft registration of 1918 Emil's saloon was listed at 500 Market Street in Redding. By family history Amelia operated the rooming house in the Zeis Building and Emil ran the bar downstairs. The couple felt the building was a bad environment for the children and moved to East Street before moving to Oakland. When the couple left Shasta County, John William "Bud" remained in Redding and his family is still represented in Shasta County. In 1930 Emil was working as a house carpenter in Oakland. Emil died in 1940 and Amelia in 1955 (both are buried in Alameda County).

The fourth son John born in Oregon in 1876 is the only child to remain in Oregon when the family first moved. In 1906 John was in Portland with Wulf & Zeis running a boarding house. In 1908 he was listed as a partner in Zeis & Droege in Portland operating the Olympic Hotel and Olympic Café. In 1920 John was listed as a partner in a farm in Washington County, Oregon. John died in 1926 and was buried at the Redding Memorial Cemetery.

The fifth son Louis born in 1879 in Oregon was listed as a day laborer in Corvallis County, Oregon in 1900. About 1905 Louis married a girl named Rose born

about 1886 in Colorado. In 1910 the couple were living at Delta where Louis was a wholesale brewery merchant. With the couple in 1910 were two children: William born about 1908 and Agnes R. (Elevyn) born about 1910. In the 1920 U.S. Census Louis worked for an ice and soda manufacturer in Sacramento while Rose worked as a home practical nurse. In 1930 Louis was listed as a farmer at Fair Oaks, Sacramento County along with his son William. Louis died in 1941 in Sacramento in 1941.

The sixth and last son was Fred Will born in 1881 in Oregon. On the 1900 U.S. Census Fred was a day laborer in Corvallis County, Oregon. In 1910 Fred was at the Sacramento River Precinct as the proprietor of an ice and soda factory. By 1918 Fred was in Redding working for Zeis & Sons and in 1930 Fred was listed as a soda bottler in Redding. Fred died in 1945 having never married.







Early Zeis & Sons bottle: below Redding was: Bottle is Never Sold.”

### The Afterthought mine

The three pictures below are the remains of the Afterthought Mine as seen from Highway 299 about twenty-four miles east of Redding in the almost deserted town of Ingot. The mine is on private property owned by the Coronado Copper and Zinc Company and has been closed since 1952. The mine now consists of 1,200 acres of mineral patents consolidated into one block in sections 10, 11, and 15 Township 33 North Range 2 West. The mine is situated in what is now called the East Shasta Copper-Zinc District. The mine's history stretches back to 1862 and came to our attention when a stock certificate issued in 1916 was found in a stack of papers.

Like most of the early mining history of Shasta County the story begins with gold and silver. Prospectors searched the area that became the North Cow Creek Mining District but it was not until 1862 that seven claims were filed as the Copper Hill Group. Although the claims produced some gold and silver they were not large producers. Some resources cite that in 1873 H. M. Peck purchased the claims for \$6,000 but the Government Land Office uses Marcus H. (Hodges) Peck born about 1842 in Michigan who was mining at Chicago in 1866. Peck probably recognized the ore as similar to the Chicago Mine and contained mainly copper, lead, zinc with secondary minerals of silver and gold. At first the ore was carried by pack up to the Fort Crook Road then shipped via Stockton to Wales for smelting. The returns were so favorable that Peck made improvements on the claim then named the Peck Mine including roads and in 1875 built a small reverberatory furnace on site that used wood to reduce the ore. (a reverberatory furnace separates the furnace fuels from the ore but not combustion gas while a blast furnace mixes the fuel and ore.) The attempt was not successful and the mine superintendent named Williams advised building a water-jacketed furnace using coal. The mine developed a railroad to haul the ore to the new smelter. In 1876 Peck discovered a new deposit that he patented as the Afterthought Mine from the mining term meaning an adjoining claim located after a major claim had been established. The new furnace used about a thousand bushels of coal a day and often failed. Eventually the cost became too much for Peck and he sold the mine to an English Company represented by St. Auburn & Company. The English owners quickly sold the mine in 1878 to the Afterthought Company whose investors included Dr. Olendorf, A. J. Loomis and R. H. Campbell of Shasta County and John Washington and Joseph Cone of Tehama County.

The new company reported “that the mine pays more than expenses, but the dividends are not large enough to suit the stockholders.” The next month in September 1883 the mine was closed. Five years later Joseph Enright purchased the mine and put in a new smelter closer to the mine. For periods the mine was closed. A new water-jacketed blast furnace was tried in 1896 and smelted 200 tons of ore that reduced to 32 tons of copper matte. This was in turn reduced to 11.84 tons of copper, 45 ounces of silver and \$224 worth of gold. Next to acquire the mine was the Great Western Gold Company in 1903. They build a 250-ton water-jacketed blast furnace that successfully reduced ore in 1905. The operation lasted until 1908 and

earned a return of \$350,000 annually. As a historical note the early operation of the mine centered on Furnaceville about one mile northeast of Ingot on North Cow Creek but in 1904 the Post Office at Ingot was established along with a school district and that became the new mine address.

In 1909 the Afterthought Copper Company took over the mine. The company offices were in St. Louis, Missouri, and incorporated in Arizona (see the attached stock certificate). In 1912 the company purchased the California, Shasta and Eastern Railway Company from Joe Terry and added new track to extend the line to Ingot. The railway connected to the Southern Pacific trunk line. The company built a 300-ton ore mill to grind the ore and concentrate the valuable sulfides and a reverberating furnace to smelt the metals out of the concentrate but the company was plagued by big changes in demand and prices. The company was often in debt and idle and in 1917 was refinanced and sold to Missouri oilman John T. Milliken. In 1918 he put in an oil-flotation mill to separate the ores but the attempt was not successful and the mine was often closed. Milliken died in 1920 and the company went into heavy debt. By 1923 the debt resulted in a foreclosure by the bondholders and the property was auctioned with a loss to most of the stockholders.

The California Zinc Company (owned by Glidden Paint Company) which had acquired the Bully Hill was next to acquire the Afterthought property under a lease option and built an eight and a half mile aerial cable-tram to the smelter at Bully Hill in 1925. The tram had a daily capacity for 288 tons of ore but in 1926 only 75 tons a day were shipped. In 1927 the mine again closed due falling metal prices. With the mine closed the Ingot Post Office was discontinued in 1940 and the school district was annexed to Bella Vista in 1942 but the mine had one last chance at life.

In 1946 the Coronado Copper and Zinc (owned by the Mudd family of Los Angeles) acquired the property and using diamond drills discovered new ore bodies. In 1947 the Afterthought and other claims were quit-claimed to the Afterthought Zinc Mining Company who in turn sold all their Shasta County property back to Coronado Copper and Zinc Company for \$110,000. Coronado then built a 100-ton flotation mill that began operation in 1948. The mill separated the sulfide ore into two separate concentrates: copper-lead and zinc. The copper-lead concentrate was shipped to Utah for smelting while the zinc was shipped to Montana. Again the mine was plagued by falling metal prices and was idle for a year between 1949 and 1950. When the mine reopened in July 1950 it operated continuously until August 1952 when ore reserves were depleted. Since August 1952 the mine has remained idle.

In the end about sixteen ore bodies of either massive sulfide or banded lower grade material were mined using 17,200 feet of drifts, crosscuts and stopes and 2,200 feet of shafts and raises. The mine was developed at ten levels with a vertical extent of 729 feet.







Ruins of the Afterthought Mine as seen from Highway 299

INCORPORATED UNDER THE LAWS OF THE  
Territory (now State)  
of Arizona



# Afterthought Copper Company

AUTHORIZED CAPITAL STOCK \$20,200,000

Preferred Stock 200,000 Shares, Par Value, \$1.00 Each.

Common Stock 2,000,000 Shares, Par Value, \$10.00 Each

This Certifies that J. E. Raymond is the owner of  
Ninety Six and Six Tenths Shares of the Common Capital  
Stock of the Afterthought Copper Company, Full Paid and Non-Assessable, transferable only  
on the Books of the Corporation in person or by Attorney on surrender of this Certificate.



In Witness Whereof, the duly authorized officers of this Corporation have hereunto  
subscribed their names and caused the corporate Seal to be hereto affixed at Ingot,  
California, this 27<sup>th</sup> day of October, A. D. 1916

E. P. Bithen Secretary

Edw. L. Carter President



21/10/14

# CERTIFICATE



## OF THE CAPITAL STOCK

### Afterthought Copper Company

ISSUED TO

DATED

**NOTICE TO HOLDERS**  
The Afterthought-Copper Company, will receive a fee of 25 cents for every share and expense of issuing new ones. Certificate No. 10, 11, 12, 13, 14, 15, 16, 17, 18, 19, 20, 21, 22, 23, 24, 25, 26, 27, 28, 29, 30, 31, 32, 33, 34, 35, 36, 37, 38, 39, 40, 41, 42, 43, 44, 45, 46, 47, 48, 49, 50, 51, 52, 53, 54, 55, 56, 57, 58, 59, 60, 61, 62, 63, 64, 65, 66, 67, 68, 69, 70, 71, 72, 73, 74, 75, 76, 77, 78, 79, 80, 81, 82, 83, 84, 85, 86, 87, 88, 89, 90, 91, 92, 93, 94, 95, 96, 97, 98, 99, 100, 101, 102, 103, 104, 105, 106, 107, 108, 109, 110, 111, 112, 113, 114, 115, 116, 117, 118, 119, 120, 121, 122, 123, 124, 125, 126, 127, 128, 129, 130, 131, 132, 133, 134, 135, 136, 137, 138, 139, 140, 141, 142, 143, 144, 145, 146, 147, 148, 149, 150, 151, 152, 153, 154, 155, 156, 157, 158, 159, 160, 161, 162, 163, 164, 165, 166, 167, 168, 169, 170, 171, 172, 173, 174, 175, 176, 177, 178, 179, 180, 181, 182, 183, 184, 185, 186, 187, 188, 189, 190, 191, 192, 193, 194, 195, 196, 197, 198, 199, 200, 201, 202, 203, 204, 205, 206, 207, 208, 209, 210, 211, 212, 213, 214, 215, 216, 217, 218, 219, 220, 221, 222, 223, 224, 225, 226, 227, 228, 229, 230, 231, 232, 233, 234, 235, 236, 237, 238, 239, 240, 241, 242, 243, 244, 245, 246, 247, 248, 249, 250, 251, 252, 253, 254, 255, 256, 257, 258, 259, 260, 261, 262, 263, 264, 265, 266, 267, 268, 269, 270, 271, 272, 273, 274, 275, 276, 277, 278, 279, 280, 281, 282, 283, 284, 285, 286, 287, 288, 289, 290, 291, 292, 293, 294, 295, 296, 297, 298, 299, 300, 301, 302, 303, 304, 305, 306, 307, 308, 309, 310, 311, 312, 313, 314, 315, 316, 317, 318, 319, 320, 321, 322, 323, 324, 325, 326, 327, 328, 329, 330, 331, 332, 333, 334, 335, 336, 337, 338, 339, 340, 341, 342, 343, 344, 345, 346, 347, 348, 349, 350, 351, 352, 353, 354, 355, 356, 357, 358, 359, 360, 361, 362, 363, 364, 365, 366, 367, 368, 369, 370, 371, 372, 373, 374, 375, 376, 377, 378, 379, 380, 381, 382, 383, 384, 385, 386, 387, 388, 389, 390, 391, 392, 393, 394, 395, 396, 397, 398, 399, 400, 401, 402, 403, 404, 405, 406, 407, 408, 409, 410, 411, 412, 413, 414, 415, 416, 417, 418, 419, 420, 421, 422, 423, 424, 425, 426, 427, 428, 429, 430, 431, 432, 433, 434, 435, 436, 437, 438, 439, 440, 441, 442, 443, 444, 445, 446, 447, 448, 449, 450, 451, 452, 453, 454, 455, 456, 457, 458, 459, 460, 461, 462, 463, 464, 465, 466, 467, 468, 469, 470, 471, 472, 473, 474, 475, 476, 477, 478, 479, 480, 481, 482, 483, 484, 485, 486, 487, 488, 489, 490, 491, 492, 493, 494, 495, 496, 497, 498, 499, 500, 501, 502, 503, 504, 505, 506, 507, 508, 509, 510, 511, 512, 513, 514, 515, 516, 517, 518, 519, 520, 521, 522, 523, 524, 525, 526, 527, 528, 529, 530, 531, 532, 533, 534, 535, 536, 537, 538, 539, 540, 541, 542, 543, 544, 545, 546, 547, 548, 549, 550, 551, 552, 553, 554, 555, 556, 557, 558, 559, 560, 561, 562, 563, 564, 565, 566, 567, 568, 569, 570, 571, 572, 573, 574, 575, 576, 577, 578, 579, 580, 581, 582, 583, 584, 585, 586, 587, 588, 589, 590, 591, 592, 593, 594, 595, 596, 597, 598, 599, 600, 601, 602, 603, 604, 605, 606, 607, 608, 609, 610, 611, 612, 613, 614, 615, 616, 617, 618, 619, 620, 621, 622, 623, 624, 625, 626, 627, 628, 629, 630, 631, 632, 633, 634, 635, 636, 637, 638, 639, 640, 641, 642, 643, 644, 645, 646, 647, 648, 649, 650, 651, 652, 653, 654, 655, 656, 657, 658, 659, 660, 661, 662, 663, 664, 665, 666, 667, 668, 669, 670, 671, 672, 673, 674, 675, 676, 677, 678, 679, 680, 681, 682, 683, 684, 685, 686, 687, 688, 689, 690, 691, 692, 693, 694, 695, 696, 697, 698, 699, 700, 701, 702, 703, 704, 705, 706, 707, 708, 709, 710, 711, 712, 713, 714, 715, 716, 717, 718, 719, 720, 721, 722, 723, 724, 725, 726, 727, 728, 729, 730, 731, 732, 733, 734, 735, 736, 737, 738, 739, 740, 741, 742, 743, 744, 745, 746, 747, 748, 749, 750, 751, 752, 753, 754, 755, 756, 757, 758, 759, 760, 761, 762, 763, 764, 765, 766, 767, 768, 769, 770, 771, 772, 773, 774, 775, 776, 777, 778, 779, 780, 781, 782, 783, 784, 785, 786, 787, 788, 789, 790, 791, 792, 793, 794, 795, 796, 797, 798, 799, 800, 801, 802, 803, 804, 805, 806, 807, 808, 809, 810, 811, 812, 813, 814, 815, 816, 817, 818, 819, 820, 821, 822, 823, 824, 825, 826, 827, 828, 829, 830, 831, 832, 833, 834, 835, 836, 837, 838, 839, 840, 841, 842, 843, 844, 845, 846, 847, 848, 849, 850, 851, 852, 853, 854, 855, 856, 857, 858, 859, 860, 861, 862, 863, 864, 865, 866, 867, 868, 869, 870, 871, 872, 873, 874, 875, 876, 877, 878, 879, 880, 881, 882, 883, 884, 885, 886, 887, 888, 889, 890, 891, 892, 893, 894, 895, 896, 897, 898, 899, 900, 901, 902, 903, 904, 905, 906, 907, 908, 909, 910, 911, 912, 913, 914, 915, 916, 917, 918, 919, 920, 921, 922, 923, 924, 925, 926, 927, 928, 929, 930, 931, 932, 933, 934, 935, 936, 937, 938, 939, 940, 941, 942, 943, 944, 945, 946, 947, 948, 949, 950, 951, 952, 953, 954, 955, 956, 957, 958, 959, 960, 961, 962, 963, 964, 965, 966, 967, 968, 969, 970, 971, 972, 973, 974, 975, 976, 977, 978, 979, 980, 981, 982, 983, 984, 985, 986, 987, 988, 989, 990, 991, 992, 993, 994, 995, 996, 997, 998, 999, 1000.

Five shares of stock within enclosed and hereby authorized  
to receive dividend on money and things and things

Share of stock within enclosed and hereby authorized

to make the necessary transfer on the books of the Corporation  
Whereas the enclosed and hereby authorized

Witness my hand and seal this 10th day of  
November 1914  
Secretary of the Corporation  
Afterthought Copper Company  
Copperopolis, Pennsylvania

